

## 2001 Ford Ranger

2000-01 DRIVE AXLES 4WD Axle Shafts - Front - Explorer, Mountaineer & Ranger

### 2000-01 DRIVE AXLES

#### 4WD Axle Shafts - Front - Explorer, Mountaineer & Ranger

## DESCRIPTION

The front wheel axle shafts use a Constant Velocity (CV) joint at both the inboard and outboard ends for operating smoothness. The CV joints do not normally contribute to rotational vibration that may occur. The only replaceable components of the front wheel axle shafts are:

- Axle shaft and CV joint boots (inboard and outboard). This replacement kit includes axle shaft, CV joint boots, clamps, snap rings, retainer ring and grease.
- Inboard CV joint (plunge type).
- Half-shaft. Replacement includes the outboard front wheel half-shaft joint (fixed type), outboard boot, clamps, front wheel excluder seal (assembled on interconnecting shaft).

**NOTE: Unless otherwise noted, references to Explorer include Explorer Sport and Explorer Sport Trac models.**

## 2001 Ford Ranger

2000-01 DRIVE AXLES 4WD Axle Shafts - Front - Explorer, Mountaineer & Ranger

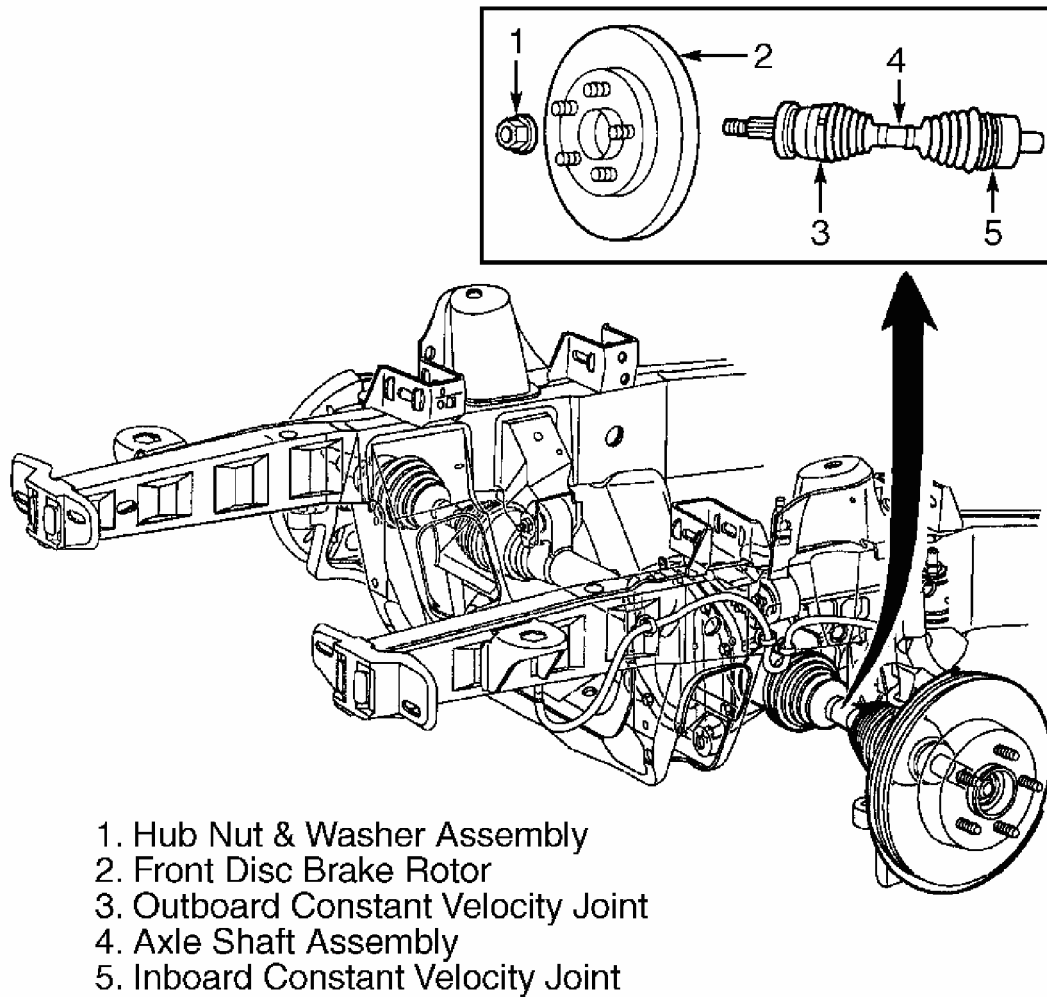

G99G02771

**Fig. 1: Identifying Front Axle Shafts**  
Courtesy of FORD MOTOR CO.

### LUBRICATION

Inner and outer CV joints require Ford High Temp Durability Grease (ESP-M1C207-AH).

### TROUBLE SHOOTING

See appropriate table in TROUBLE SHOOTING article in GENERAL INFORMATION.

### REMOVAL & INSTALLATION

#### FWD AXLE SHAFTS

**WARNING:** Electrical power to air suspension system must be shut off

**prior to hoisting, jacking or towing an air suspension vehicle. This can be accomplished by turning off the air suspension switch located in rear jack storage area. Failure to do so may result in unexpected inflation or deflation of air springs which may result in shifting of vehicle during servicing.**

### Removal & Installation

**CAUTION: Do not use heat to loosen a seized lug nut. Heat can damage wheel and bearings.**

1. Remove locking hub assembly, if equipped. Using snap ring pliers, remove plastic stub shaft retainer. Remove center cap, if equipped. On all models, with the weight of the vehicle on the wheels, loosen lug nuts. Raise and support vehicle. Remove wheel and tire assembly. Remove and discard wheel hub retainer nut and washer assembly. See **Fig. 1** . Remove 2 front brake caliper mounting bolts. Lift brake caliper off of front disc brake caliper anchor plate, and wire caliper aside.
2. Remove cotter pin and tie rod nut. Separate ball joint. On Explorer and Mountaineer, remove stabilizer bar link. On all models, unclip ABS wiring harness, if equipped. Remove ABS wiring harness from knuckle, if equipped. On Explorer Sport and Explorer Sport Trac, remove nuts and disconnect right shock absorber from lower control arm.

**CAUTION: Do not use a hammer to separate half-shaft joint from hub assembly. Damage to outboard CV joint stub shaft housing threads and internal components may result.**

3. On all models, install Front Hub Remover/Installer (T93P-1175-B) and separate half-shaft from hub. Support front suspension lower arm. Remove upper ball joint to front wheel knuckle nut and bolt. Rotate front steering knuckle. Compress outboard half-shaft joint and remove outboard half-shaft joint from hub.
4. Using CV Joint Puller (T89P-3514-A), separate front wheel half-shaft from front axle housing. Remove half-shaft from front axle housing. To install, reverse removal procedure. Use a NEW circlip on inboard CV joint stub shaft housing. On Explorer and Mountaineer, install NEW wheel hub nut. On all models, tighten nut to specification. See **TORQUE SPECIFICATIONS** .

## OVERHAUL

### FWD AXLE SHAFTS

#### Disassembly

## 2001 Ford Ranger

2000-01 DRIVE AXLES 4WD Axle Shafts - Front - Explorer, Mountaineer & Ranger

1. Remove axle shaft from vehicle. See **FWD AXLE SHAFTS** under REMOVAL & INSTALLATION. Place axle shaft assembly on work bench. Remove 2 inboard boot clamps. See **Fig. 2** . Slide boot off inboard CV joint housing. Separate CV joint from CV joint housing. Mark half-shaft-to-tripod joint for reassembly reference. Remove snap ring from end of half-shaft. Remove CV joint.
2. Remove inboard CV joint boot from shaft assembly. Remove 2 outboard boot clamps. Remove outboard CV joint boot. Inspect for contaminated grease. If grease is contaminated, clean and inspect joint for wear. Replace outboard CV joint and shaft assembly if worn or damaged.

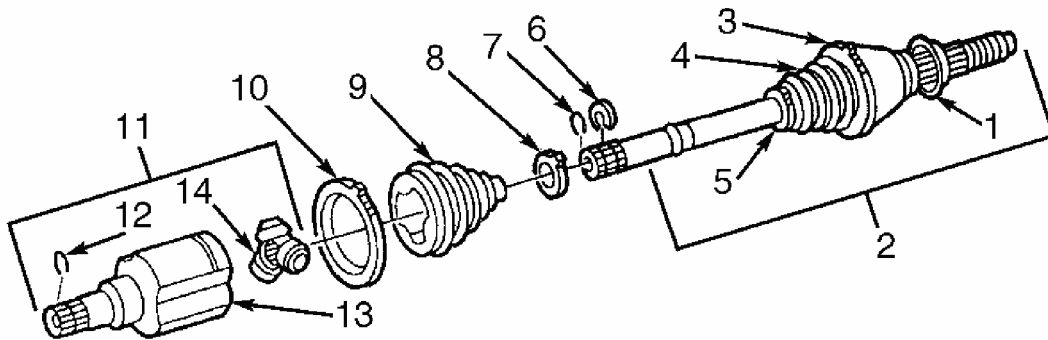

- |                              |                               |
|------------------------------|-------------------------------|
| 1. Front Wheel Excluder Seal | 8. Boot Clamp                 |
| 2. Half-Shaft Assembly       | 9. CV Joint Boot              |
| 3. Boot Clamp                | 10. Boot Clamp                |
| 4. CV Joint Boot             | 11. Inboard CV Joint Assembly |
| 5. Boot Clamp                | 12. Circlip                   |
| 6. Stop Ring                 | 13. CV Joint Housing          |
| 7. Circlip                   | 14. Tripod Joint              |

G99102772

**Fig. 2: Identifying Front Axle Shafts Components**  
Courtesy of FORD MOTOR CO.

### Reassembly

1. Pack outboard CV joint with Ford High Temp Durability Grease (ESP-M1C207-AH). Spread any remaining grease from service kit evenly inside outboard CV joint boot.
2. Clean excess grease from CV joint boot mounting surfaces before positioning boot in place. Position outboard half-shaft boot on CV joint housing. Position boot clamps on outboard CV joint boot.
3. Using CV Boot Clamp Installer (T95P-3514-A), tighten outboard CV joint boot clamps. Position inboard CV joint boot. Align half-shaft-to-tripod joint marks made during disassembly. Install tripod joint on half-shaft. Install snap ring. Using high-temp grease, lubricate tripod joint needle bearings.

## 2001 Ford Ranger

2000-01 DRIVE AXLES 4WD Axle Shafts - Front - Explorer, Mountaineer & Ranger

4. Fill inboard CV joint housing with Ford High Temp Durability Grease. Position CV joint housing onto tripod joint. Remove any excess grease from inboard CV joint boot mating surface before positioning boot into place.
5. Position inboard CV joint boot and boot clamp. Insert a dull-blade screwdriver to relieve built-up air pressure in CV joint boot. Using CV Boot Clamp Installer, tighten inboard boot clamps. Install axle shaft assembly.

### TORQUE SPECIFICATIONS

#### TORQUE SPECIFICATIONS

Application	Ft. Lbs. (N.m)
Caliper Bolts	
Explorer & Mountaineer	24 (33)
Ranger	84 (114)
Lug Nuts	
100 (136)	
Upper Ball Joint Nut	
Explorer & Mountaineer	51 (69)
Ranger	41 (56)
Wheel Hub Nut	
Explorer & Mountaineer	<sup>(1)</sup> 184 (249)
Ranger	162 (220)
(1) Install NEW nut.	